

## Digital infra-red sensor for measuring surface temperature FIAD43 Miniature probe head, integrated electronics, ALMEMO® D6 plug

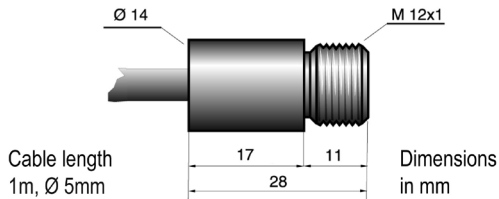

### Measuring Field

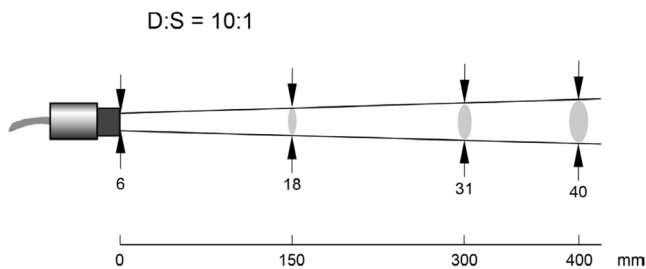

- Digital infra-red probe head with integrated signal processor
- All sensor characteristics and adjustment data are stored in the probe head itself.
- Digital transmission ensures that measured values are not affected by the sensor cable being moved, bent, or twisted.
- Surface temperature is measured over a wide range up to 600°C.
- Robust stainless steel housing, protection class IP65
- The probe head, thanks to its small dimensions, can be installed in cramped and restricted conditions.
- The probe head is threaded for quick and easy installation.
- The sensor cable in polyurethane (PUR) is suitable for industrial use and is resistant to oily, acidic, basic environments.
- The sensor can be connected directly via the cable's ALMEMO® D6 plug to any ALMEMO® device.
- One measuring channel is preprogrammed on leaving our factory - surface temperature (°C).
- Emissivity 0.95 are preprogrammed (on leaving our factory).
- This can be programmed from 0.1 to 1.0 at the current ALMEMO® V6 devices via the device or via interface (some only via interface).
- Transmittance 1.0 is preprogrammed (on leaving our factory). When using the focal point lens attachment or the protective window, the transmittance of the focal point lens attachment or the protection window must be adjusted. Transmittance can be modified in the ALMEMO® D6 sensor menu directly on the PC using USB adapter cable ZA1919AKUV (see page 04.05) 35/5000 or with an ALMEMO® V7 measuring device..

**General features and accessories, ALMEMO® D6 sensors**  
see page 01.08

### Options fitted at our factory



Air blower attachment

OR7843LB



Deflecting mirror with integrated air blower attachment

OR7843US1

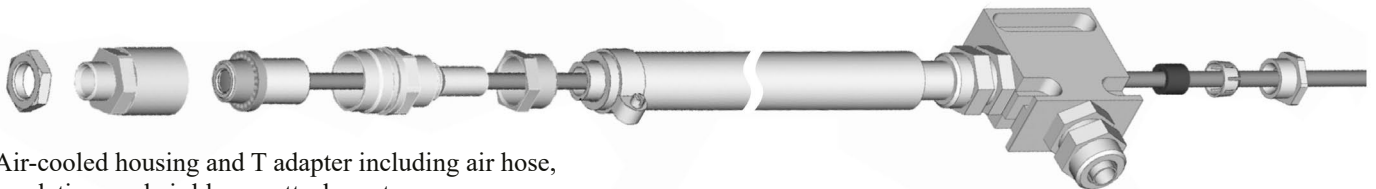

Air-cooled housing and T adapter including air hose, insulation, and air blower attachment

Length of air hose 0.8 meters

OR7843KL1

Length of air hose 2.8 meters

OR7843KL2



Deflecting mirror for air-cooled housing

OR7843US

### Standard delivery

Infra-red probe head with cable and ALMEMO® D6 plug and 1 mounting nut

Cable length = 1 meter

Cable length = 3 meters

### Order no.

FIAD4332

FIAD4332L3

DAkS or factory calibration KI9xxx temperature for digital sensor (see chapter Calibration certificates).  
DAkS calibration meets all the requirements regarding test resources laid down in DIN EN ISO/IEC 17025.

## Technical data

### Digital infra-red probe head (including A/D converter)

Temperature measuring range	-40 to +600 °C		
Spectral sensitivity	8 to 14 µm		
Optical resolution (90 % energy)	10:1 with focal point lens attachment 1 mm at distance of 10 mm Transmittance can be programmed to 0.75. (see below)		
Accuracy	±1 % of meas. value or ±1 K (whichever value is higher) ±2 K for meas. values <20 °C		
Reproducibility	±0.5 % of measured value or ±0.5 K (whichever value is higher)		
Nominal conditions	23 °C ±5 K, emissivity 1.0		
Temperature coefficient	±0.05 K / K or ±0.05 % of measured value / K (whichever value is higher)		
Temperature resolution	0.1 K		
Response time	130 ms (90 %)		
Emissivity	0.95 (preprogrammed on leaving our factory) This can be programmed from 0.1 to 1.0 at the current ALMEMO® V6 devices via the device (some only via interface).		
Transmittance the focal point lens attachment or the protective window :	1.0 (preprogrammed on leaving our factory) This can be programmed from 0.1 to 1.0 directly on the PC using USB adapter cable ZA1919AKUV. (please place a special order) (see "General accessories for ALMEMO® D6 sensors")		
Protection class	IP65 (NEMA 4) (National Electric Manufacturers Association)		
Ambient temperature	-10 to +120 °C with air-cooled housing -10 to +200 °C		
Storage temperature	-20 to +120 °C		
Relative atmospheric humidity	10 to 95 % non-condensing		
Housing	Stainless steel		
Dimensions	Probe head Length 28 mm x Ø 14 mm Thread M12 x 1		
Weight	Probe head 50 grams with 1-meter cable		
Connecting cable(s)	permanently fitted with ALMEMO® D6 plug	Polyurethane (PUR)	For available lengths see variants.
ALMEMO® D6 plug	Refresh time	0.25 seconds for all channels	
	Supply voltage	6 to 13 VDC	
	Current consumption	4 mA	

## Accessories

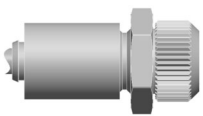

Focal point lens attachment (cannot be used together with air blower attachment or air-cooled housing)  
Transmittance 0.75

ZR7843CFL



Protective window (cannot be used together with air blower attachment or air-cooled housing)  
Transmittance 0.75

ZR7843PW



Mounting bracket, rigid

ZR7842H



Mounting bracket, adjustable

ZR7842JH

Measuring field with focal point lens attachment

